

## BACH / BAEC Balustrade Channel and End Cap

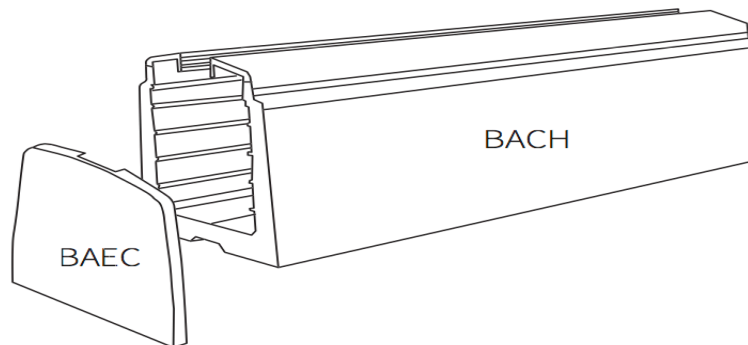

### SIDE VIEW

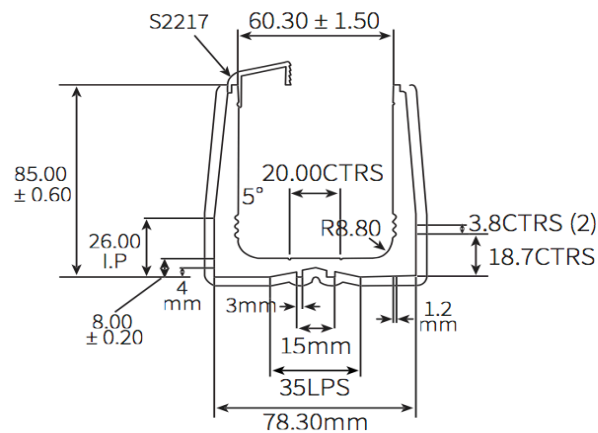

#### AVAILABLE FINISHES

- Mill finish
- Silver pearl powdercoat

#### TECHNICAL DETAILS

- 5.8m stock length
- Suitable for 12 and 15mm glass

## BIGFOOT CHANNEL

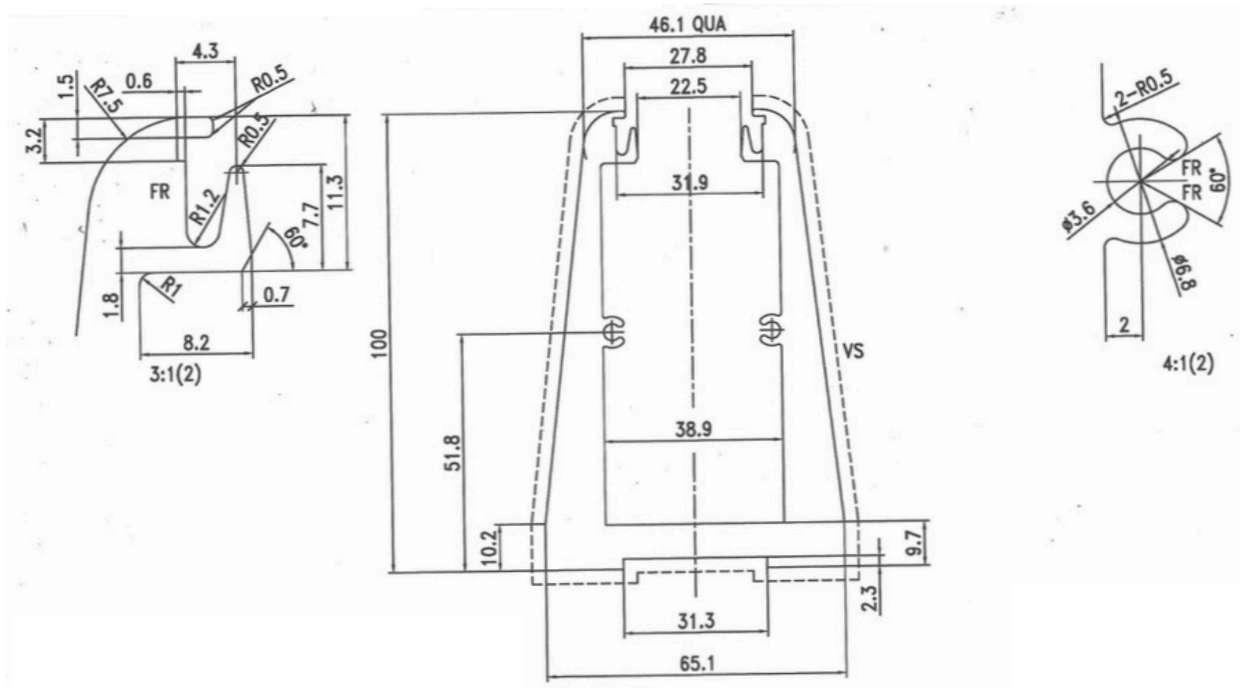

## AVAILABLE FINISHES

- Mill finish

## TECHNICAL DETAILS

- 6m stock length
- Suitable for 12 and 15mm glass

## GLASS BALUSTRADE PANELS 12mm Standard Panels

## 12mm Standard Panels with Polished Edges &amp; 2mm Polished Radius

CODE	WIDE (mm)	HEIGHT (mm)	AREA (sqm)
BG12-100	100	970	0.10
BG12-150	150	970	0.15
BG12-200	200	970	0.19
BG12-250	250	970	0.24
BG12-300	300	970	0.29
BG12-350	400	970	0.34
BG12-400	400	970	0.38
BG12-450	450	970	0.44
BG12-500	500	970	0.48
BG12-550	550	970	0.53
BG12-600	600	970	0.58
BG12-650	650	970	0.63
BG12-700	700	970	0.67
BG12-750	750	970	0.73
BG12-800	800	970	0.77
BG12-850	850	970	0.82
BG12-900	900	970	0.87
BG12-950	950	970	0.92
BG12-1000	1000	970	0.97
BG12-1050	1050	970	1.01
BG12-1100	1100	970	1.06
BG12-1150	1150	970	1.11
BG12-1200	1200	970	1.16
BG12-1250	1250	970	1.21
BG12-1300	1300	970	1.26
BG12-1350	1350	970	1.3
BG12-1400	1400	970	1.36
BG12-1450	1450	970	1.4
BG12-1500	1500	970	1.45
BG12-1550	1550	970	1.5
BG12-1600	1600	970	1.55
BG12-1650	1650	970	1.6
BG12-1700	1700	970	1.65
BG12-1750	1750	970	1.7
BG12-1800	1800	970	1.75
BG12-1850	1850	970	1.79
BG12-1900	1900	970	1.85
BG12-1950	1950	970	1.89
BG12-2000	2000	970	1.94

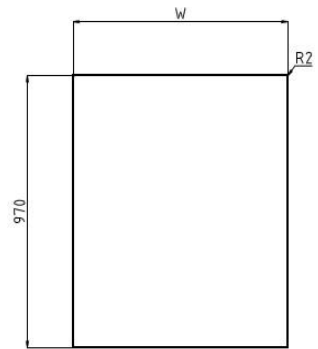

## GLASS BALUSTRADE PANELS With 2 Holes

## Balustrade Panels with 2 Holes

CODE	WIDE (mm)	HEIGHT (mm)	AREA (sqm)
BGHG12-600	600	970	0.58
BGHG12-650	650	970	0.63
BGHG12-700	700	970	0.68
BGHG12-750	750	970	0.73
BGHG12-800	800	970	0.78
BGHG12-850	850	970	0.82
BGHG12-900	900	970	0.87
BGHG12-950	950	970	0.92
BGHG12-1000	1000	970	0.97
BGHG12-1050	1050	970	1.02
BGHG12-1100	1100	970	1.07
BGHG12-1150	1150	970	1.12
BGHG12-1200	1200	970	1.16
BGHG12-1250	1250	970	1.21
BGHG12-1300	1300	970	1.26
BGHG12-1350	1350	970	1.31
BGHG12-1400	1400	970	1.36
BGHG12-1450	1450	970	1.41
BGHG12-1500	1500	970	1.46
BGHG12-1550	1550	970	1.5
BGHG12-1600	1600	970	1.55
BGHG12-1650	1650	970	1.6
BGHG12-1700	1700	970	1.65
BGHG12-1750	1750	970	1.7
BGHG12-1800	1800	970	1.75

## Balustrade Glass with Holes for Handrail

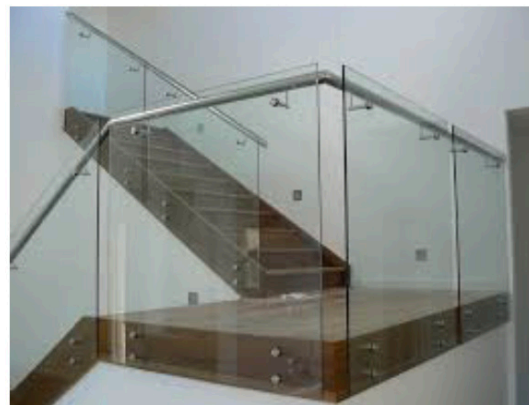
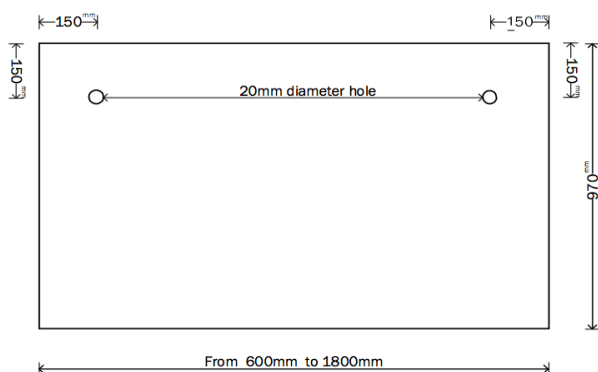

## GLASS BALUSTRADE PANELS 4 / 6 Holes

## Balustrade Panels with 4/6 Holes

CODE	WIDE (mm)	HEIGHT (mm)	AREA (sqm)	HOLES
BGHG12-600	600	1280	0.77	4 Holes
BGHG12-650	650	1280	0.83	4 Holes
BGHG12-700	700	1280	0.90	4 Holes
BGHG12-750	750	1280	0.96	4 Holes
BGHG12-800	800	1280	1.02	4 Holes
BGHG12-850	850	1280	1.09	4 Holes
BGHG12-900	900	1280	1.15	4 Holes
BGHG12-950	950	1280	1.22	4 Holes
BGHG12-1000	1000	1280	1.28	4 Holes
BGHG12-1050	1050	1280	1.34	4 Holes
BGHG12-1100	1100	1280	1.41	4 Holes
BGHG12-1150	1150	1280	1.47	4 Holes
BGHG12-1200	1200	1280	1.54	4 Holes
BGHG12-1250	1250	1280	1.60	4 Holes
BGHG12-1300	1300	1280	1.66	4 Holes
BGHG12-1350	1350	1280	1.73	4 Holes
BGHG12-1400	1400	1280	1.79	4 Holes
BGHG12-1450	1450	1280	1.86	4 Holes
BGHG12-1500	1500	1280	1.92	6 Holes
BGHG12-1550	1550	1280	1.98	6 Holes
BGHG12-1600	1600	1280	2.05	6 Holes
BGHG12-1650	1650	1280	2.11	6 Holes
BGHG12-1700	1700	1280	2.18	6 Holes
BGHG12-1750	1750	1280	2.24	6 Holes
BGHG12-1800	1800	1280	2.30	6 Holes

## 12MM TOUGHENED GLASS Side Fixing Standard Size Panel

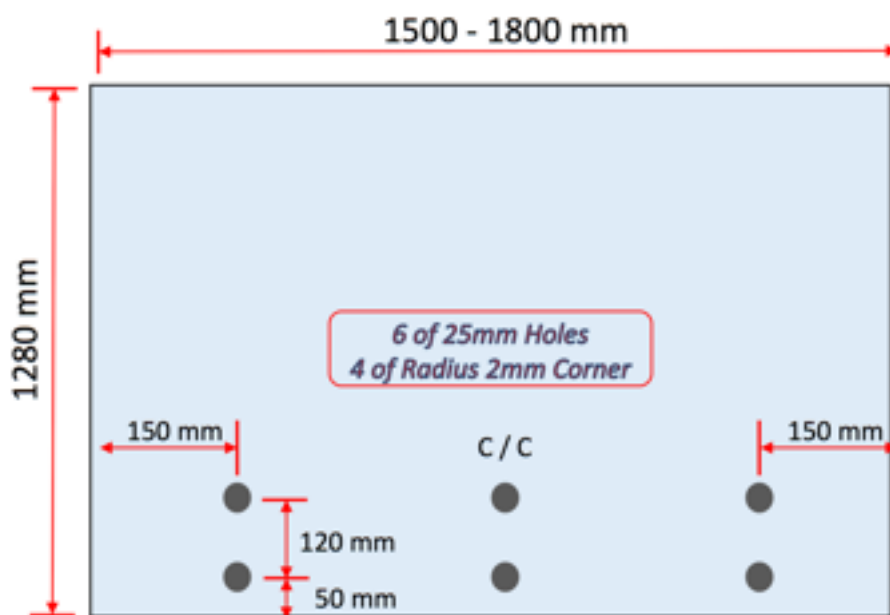
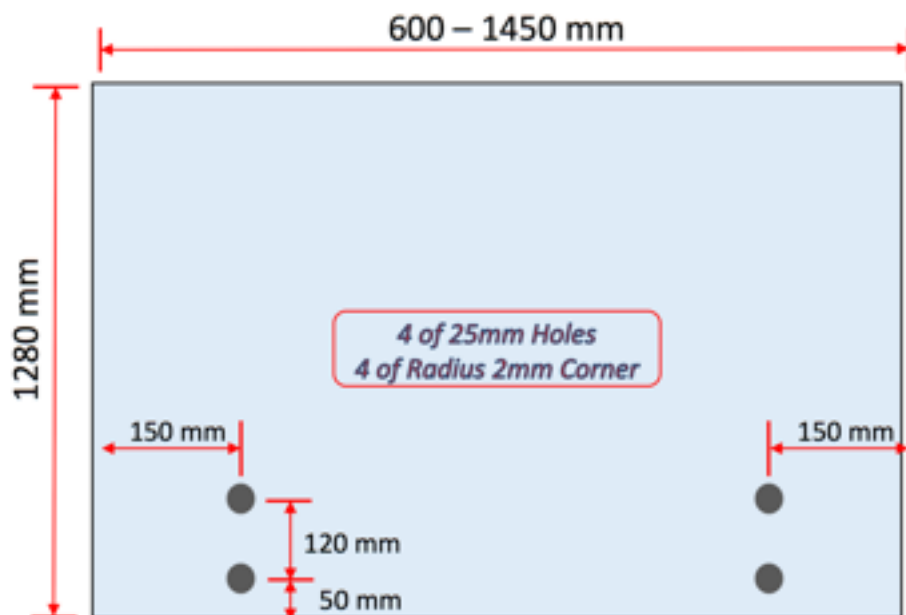

## AVAILABLE FINISHES

- 12mm Clear Toughened Glass

## TECHNICAL DETAILS

- Side fixing standard size panel

## POSIGLAZE Glass Balustrade System



### DESCRIPTION

The PosiGlaze Glass Balustrade System was developed for cantilevered structural balustrades to cope with the transition from monolithic toughened safety glass to toughened laminated safety glass.

The unique design uses a special high strength hollow core aluminium extrusion and special glass clamp kits that clamp the glass and locate into the section. This means the system can be used on 12, 15, & 19mm toughened safety glass and 13.5, 17.5 and 21.5 laminated safety glass without holes in the glass. Holes can make the systems more complex and often the holes are the point of failure.

The other key to PosiGlaze is its clever locating and adjusting technique which allows the installers to adjust the glass panels once in place, with a turn of a spanner, saving on installation time.

### SUITABLE FOR

The PosiGlaze Glass Balustrade System can be base fixed or side fixed for top or side (face) mounted balustrade applications.

The 120mm high x 72mm wide extrusion comes in 3 meter lengths all pre drilled ready for fixing and once the section is fitted the glass is easily dropped in and located. The systems also make re-glazing easy, or the glass type or thickness can be easily changed to a later date.

A top seal strip section and gasket are installed after the glass has been adjusted to give a clean top edge look and matching end caps complete the system.

For the side fixed systems an additional clip on side cladding and tapered base cladding section is used for aesthetics and to cover the fixing holes.

### AVAILABLE FINISHES

The sections and cover are fully anodized for durability and come standard in a unique brushed anodized finish which give a "Stainless Steel Effect".

Other aluminium finishes are available on request.

## PG120.B / PG120.S / PG180.S PosiGlaze Balustrade System

**DESIGN AND TESTING**

The PosiGlaze Glass Balustrade System has been designed and tested to New Zealand and British Standards, which use similar occupancy types and loading requirements.

The UK testing BS 6180:2011, involved base and side fixed systems to concrete and steel a range of glass types and thicknesses from 15mm - 21mm including TLSG with EVA and SG inter layer.

The NZ testing is to AS/NZS 1170 loadings in accordance with B1/VM1 Amend 8, for Occupancy A, B, E, C3 and the higher C1, C2 and D loadings.

Therefore the systems can be used for all residential applications, except for C5 (over-crowding).

**INSTALLATION**

The PosiGlaze Glass Balustrade System can be glazed with Toughened, Heat Soaked, screen printed, Digital printed, Toughened Safety Glass (TSG) or SafeLite Toughened Laminated Safety Glass (TLSG), using either PVB, CIP, EVA or SGP interlayer. Note that the breakage characteristic can alter with different interlayer's.

(Refer to Glass Manufacturer for more details)

**COMPLIANCE**

The PosiGlaze Glass Balustrade System can be used for compliance with NZ Building Code Clause F4-Safety from falling, with barrier heights to suit the design application, normally 1 metre.

The maximum glass height is a function of the glass type, thickness, occupancy loading, and wind loading and a design table or specific design is available.

Test data and independent engineered and certified Producer Statements (PS1) are available for compliance with the NZ building code.

Heat soaked TSG is recommended for barriers with interlinking handrails or top rails.

**PG120.B**

- Base fix system
- 120mm x 72mm x 3m

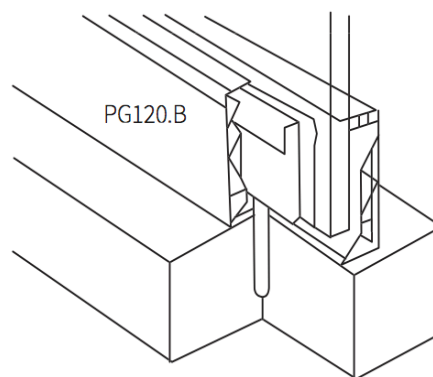
**PG120.S**

- Side fix system
- 120mm x 74mm x 3m

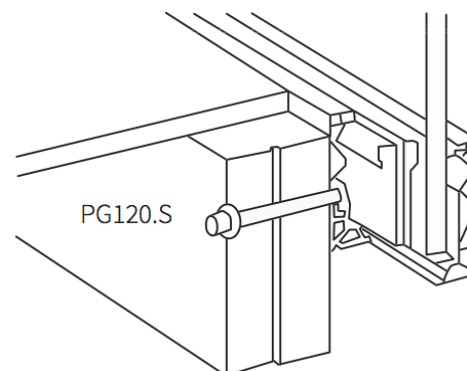
**PG180.S**

- Side fix system
- 180mm x 74mm x 3m

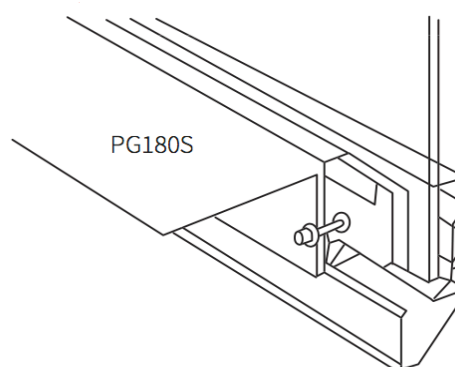



## BA124 Infinity Sidefix Glass Balustrade System

### DESCRIPTION

- Infinity sidefix glass balustrade system.
- No holes are required in the glass panels, they are simple to install, align and adjust.
- Residential A, C3 and pool fencing require 12mm toughened glass, clamps at 500mm centres with a maximum overhang of 250mm.
- Commercial B,E and C3 require 15mm toughened glass, clamps at 400mm centres with a maximum overhang of 200mm.
- PS1 and system manual with full set out details are available on request

### SUITABLE FOR

- Side fix frameless glass balustrades.
- Pool fencing and the following balustrade occupancy types - Residential A and CS, Commercial B, E and C3.

### AVAILABLE FINISHES

- Natural anodised aluminium with mill finish.
- Standard colour powder coat options also available.

### ORDER

- Specify lengths of front and rear covers, plus the required number of glass clamps. All system components can be selected on pages to follow.

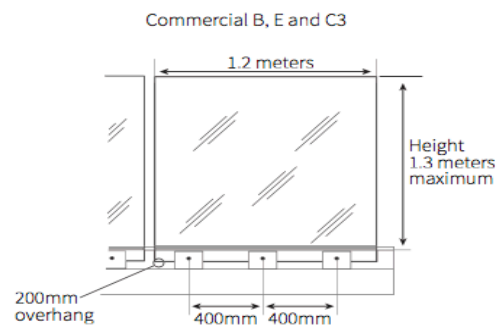
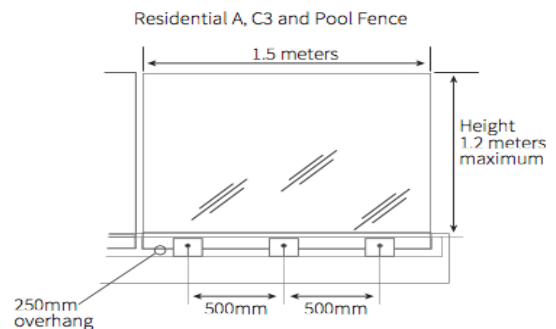
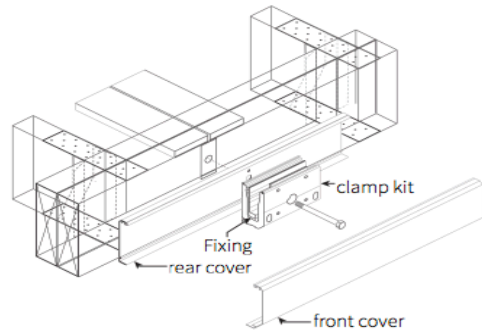
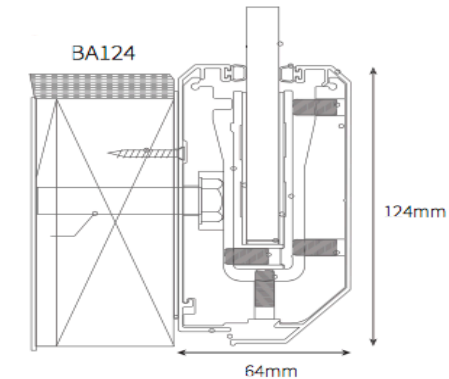

## BA124 Infinity Sidefix Glass Balustrade System

### TIMBER DECK - M12 COACH SCREW

- Occupancy
- Residential and C3 only

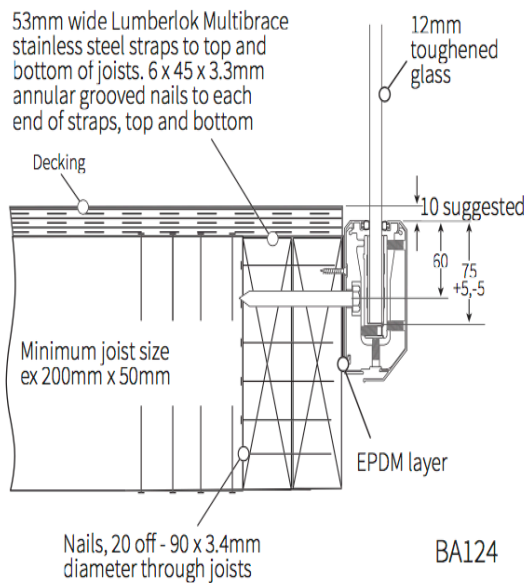

1. Coachscrews 90mm minimum thread engagement into joists.
2. Bond all coachscrews with SIKA Supergrip to full depth.
3. A rubber, EPDM or foam tape layer must be installed between the clamp and timber.

### WATERPROOF TIMBER DECK - M12 COACH SCREW

- Occupancy
- Residential and C3 only

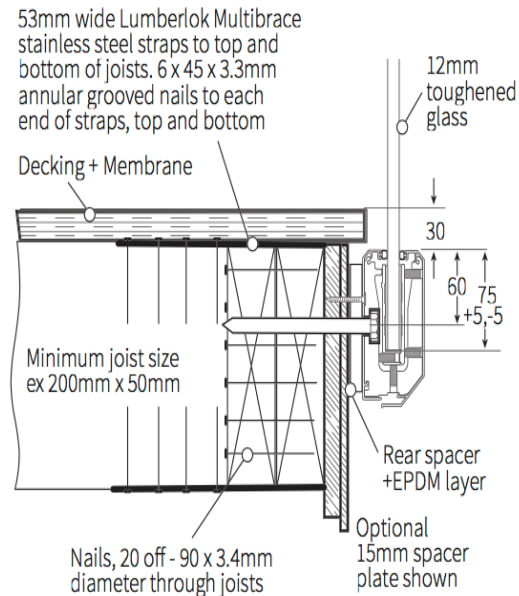

1. Coachscrews 90mm minimum thread engagement into joists.
2. Bond all coachscrews with SIKA Supergrip to full depth.
3. A rubber, EPDM or foam tape layer must be installed between the clamp and timber.

### INFINITY GLASS CLAMPS HEIGHT OPTIONS

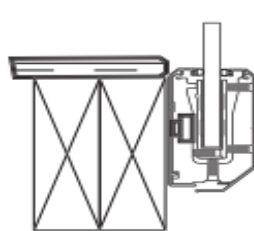

'Normal' height say 10mm below deck

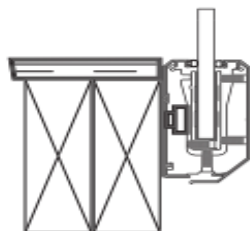

Clamp flush with deck

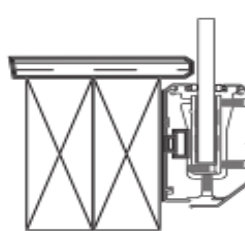

Clamp below deck

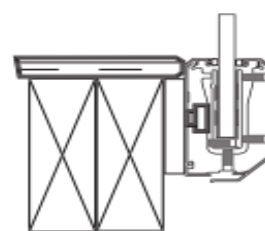

Clamp flush with deck 15mm spacer

## BA124 Infinity Sidefix Glass Balustrade System

### CONCRETE DECK - M12 STUD

- Occupancy
- Residential A & C3 = 12mm toughened glass
- Residential B, E & C3 = 15mm toughened glass

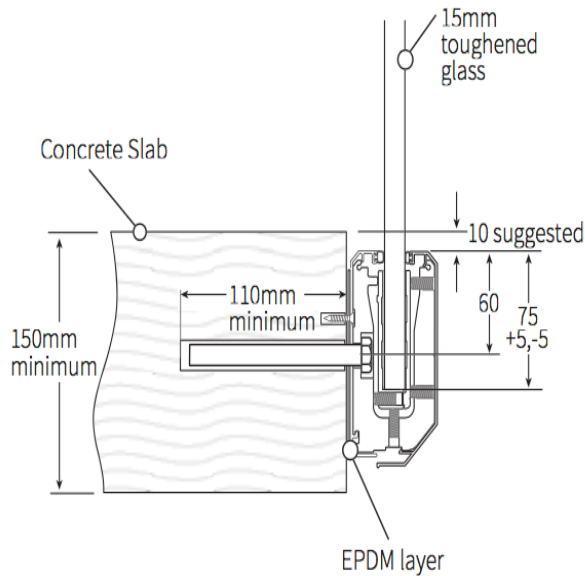

1. All fixings must engage into the structural slab.
2. A rubber, EDPM or foam type layer must be installed between the clamp and concrete.

### STEEL STRUCTURE - M12 BOLT

- Occupancy
- Residential A and C3 = 12mm glass
- Commercial B, E or C3 = 15mm glass

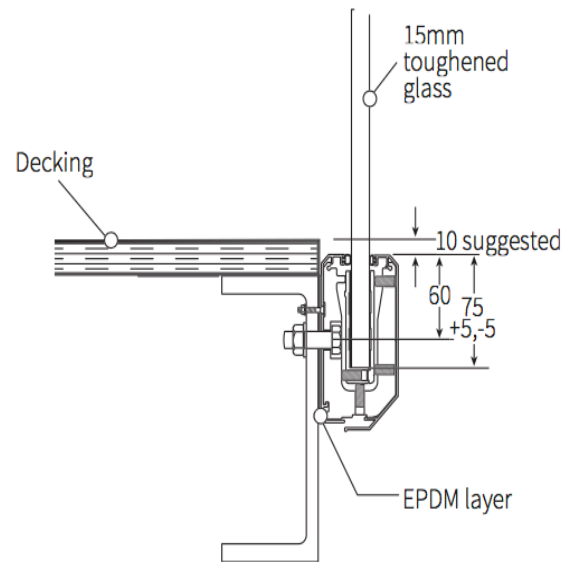

1. A rubber, EDPM or foam type layer must be installed between the clamp and steel.

### INFINITY GLASS CLAMPS HEIGHT OPTIONS

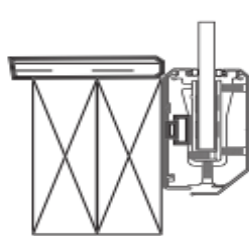

'Normal'  
height say  
10mm  
below deck

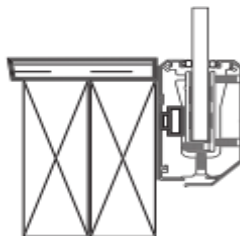

Clamp  
flush  
with deck

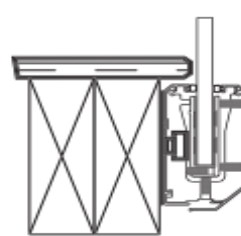

Clamp  
below  
deck

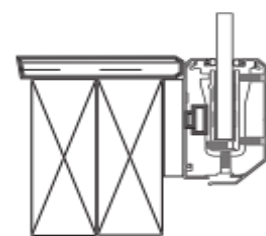

Clamp flush  
with deck  
15mm spacer

## BA124 Infinity Sidefix Glass Balustrade System

### WATERPROOF TIMBER DECK

- Occupancy
- Commercial B, E or C3

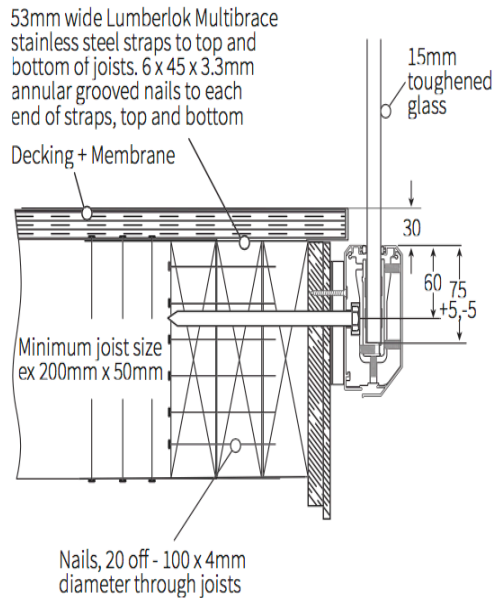

1. Coachscrews 120mm minimum thread engagement into joists.
2. Bond all coachscrews with SIKa Supergrip to full depth.
3. A rubber, EPDM or foam tape layer must be installed between the clamp and timber.

### TIMBER DECK - M12 COACH SCREW

- Occupancy
- Commercial B, E or C3

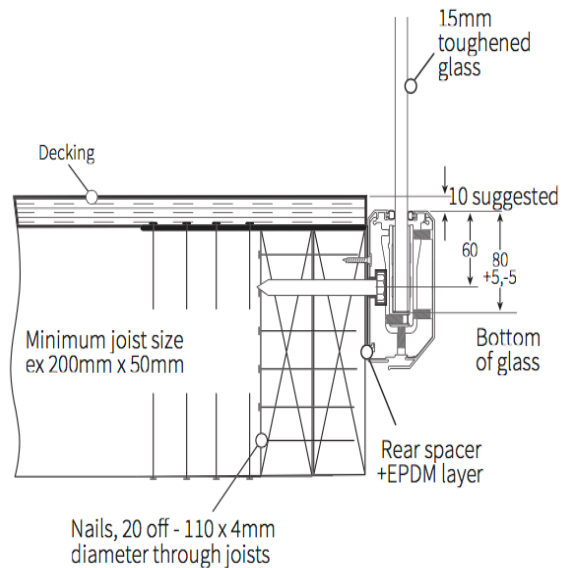

1. Coachscrews 90mm minimum thread engagement into joists.
2. Bond all coachscrews with SIKa Supergrip to full depth.
3. A rubber, EPDM or foam tape layer must be installed between the clamp and timber.

### INFINITY GLASS CLAMPS HEIGHT OPTIONS

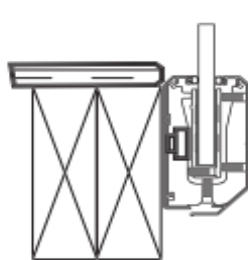

'Normal' height say 10mm below deck

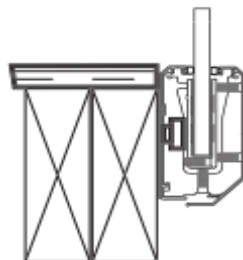

Clamp flush with deck

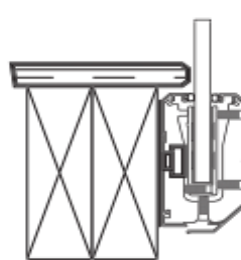

Clamp below deck

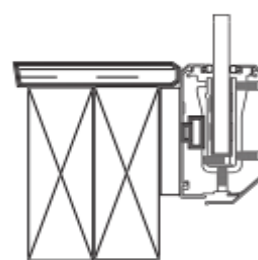

Clamp flush with deck 15mm spacer

## CKI.1 Infinity Heavy Duty Clamp Extrusion

### TECHNICAL DETAILS

- Infinity heavy duty clamp extrusion.
- The infinity balustrade clamp comes as a kit - clamp extrusion, front and rear gasket extrusions gaskets, glass bottom packer and all adjusting screws (M12 fastner not included).

### SUITABLE FOR

- 12mm, 13.52mm, 15mm, 17.52mm, 19mm and 21.52mm glass thickness.

### AVAILABLE FINISHES

- Aluminium

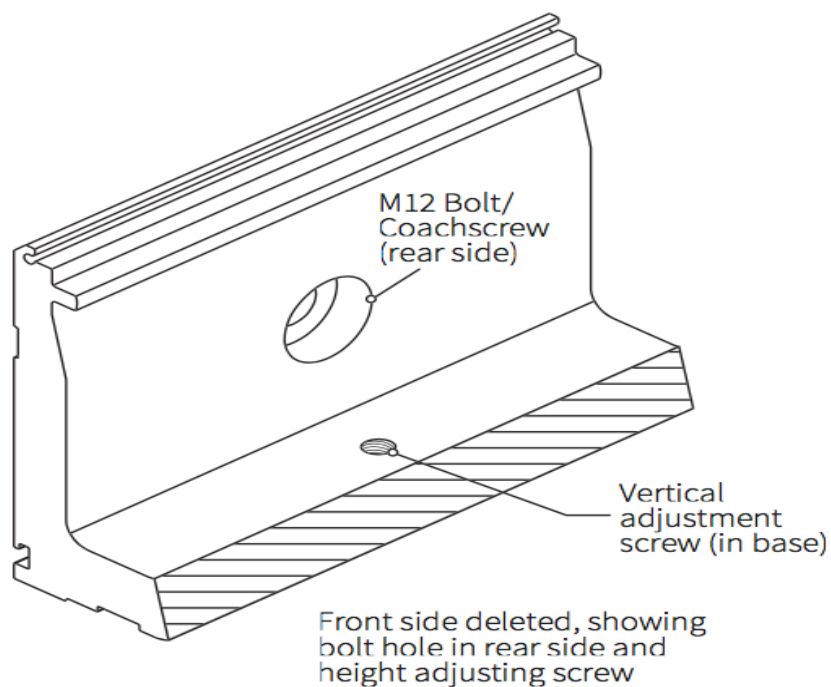
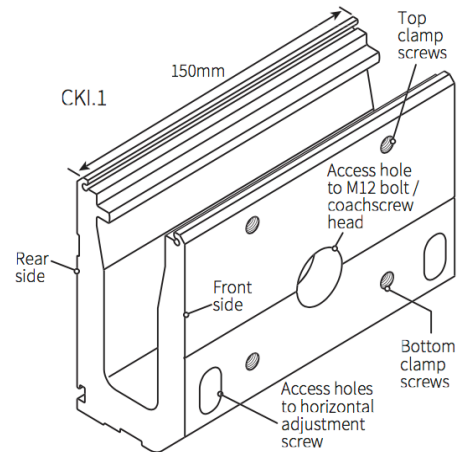

**RC1 SERIES** Rear Cover / Clamp Base with Bulb Seal (template)**RCI SERIES ITEM NUMBERS**

- RC1.118.N.5000 - 118mm height, natural anodised, 5m
- RC1.118.N.2500 - 118mm height, natural anodised, 2.5m
- RC1.118.M.5000, 118mm height, mill aluminium, 5m
- RC1.118.M.2500, 118mm height, mill aluminium, 2.5m

**SUITABLE FOR**

- Infinity system

**AVAILABLE FINISHES**

- Natural anodised
- Mill aluminium
- Standard dulux colours (same price as natural anodised if 25lm or more, if less than 25lm then P.O.A.)

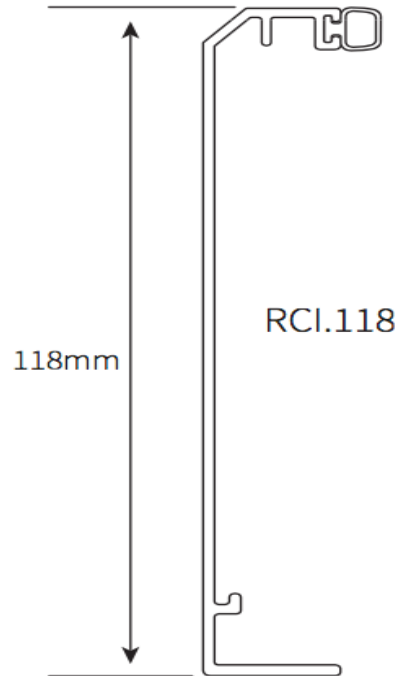
**FCI SERIES** Front Cover with Bulb Seal**RCI SERIES ITEM NUMBERS**

- FC1.124.N.5000, 124mm height, natural anodised, 5m
- FC1.124.N.2500, 124mm height, natural anodised, 2.5m
- FC1.124.M.5000, 124mm height, mill aluminium, 5m
- FC1.124.M.2500, 124mm height, mill aluminium, 2.5m

**SUITABLE FOR**

- Infinity system

**AVAILABLE FINISHES**

- Natural anodised
- Mill aluminium
- Standard dulux colours (same price as natural anodised if 25lm or more, if less than 25lm then P.O.A.)

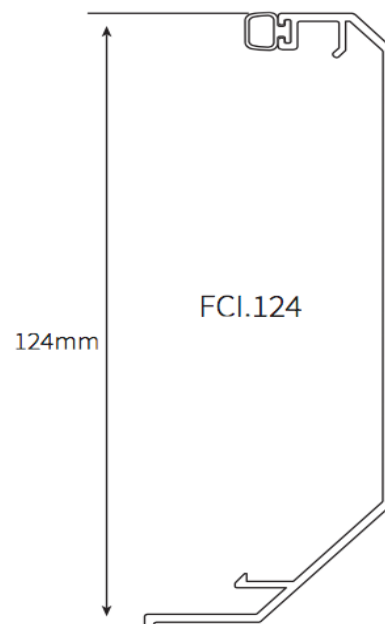

## CKI.12 Clamp Kit - 12mm glass

### TECHNICAL DETAILS

- Infinity system
- 12mm glass thickness

### AVAILABLE FINISHES

- Natural anodised
- Mill

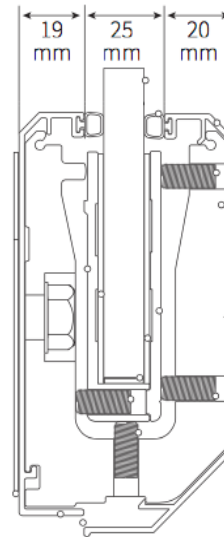

## CKI.15 Clamp Kit - 15mm glass

### TECHNICAL DETAILS

- Infinity system
- 15mm glass thickness

### AVAILABLE FINISHES

- Natural anodised
- Mill

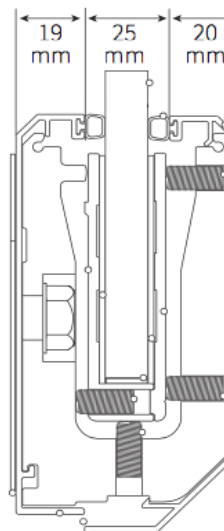

## RSI.1 Rear Cover Spacer Plate

## TECHNICAL DETAILS

- 1mm to align rear cover if structure is not straight
- Use only if required

## AVAILABLE FINISHES

- Silver frost
- Mill

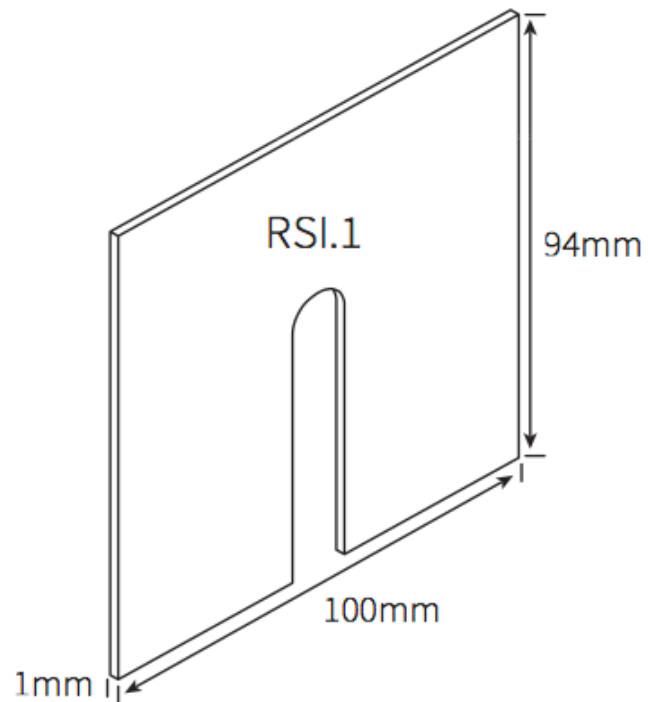

## SOI.15 Stand Off Plate

## TECHNICAL DETAILS

- Will stand the infinity system 15mm off the structure
- Use only if required

## AVAILABLE FINISHES

- Silver frost
- Mill

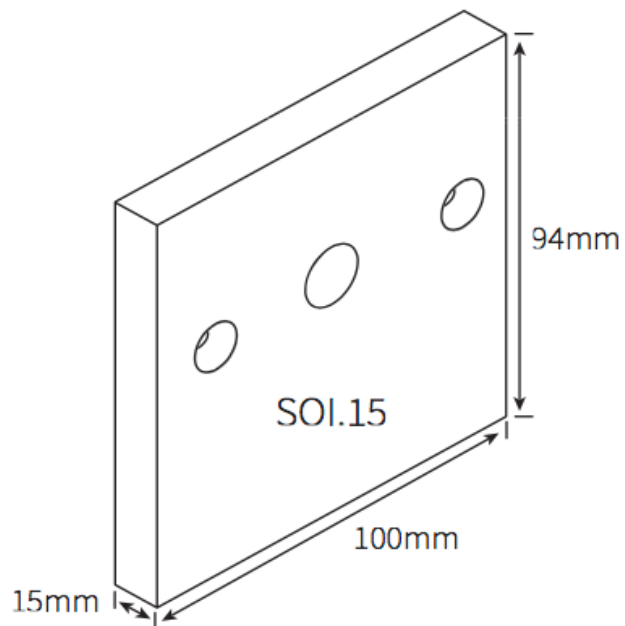



**EC.124.6 / EC.124.7 Extrusion End Cap****TECHNICAL DETAILS**

- EC1.124.6, no.6 plastic plug + 6g x 25 SS CS screw
- EC1.124.7, no.7 plastic plug + z x 25 SS CS screw

**AVAILABLE FINISHES**

- Natural anodised
- Mill

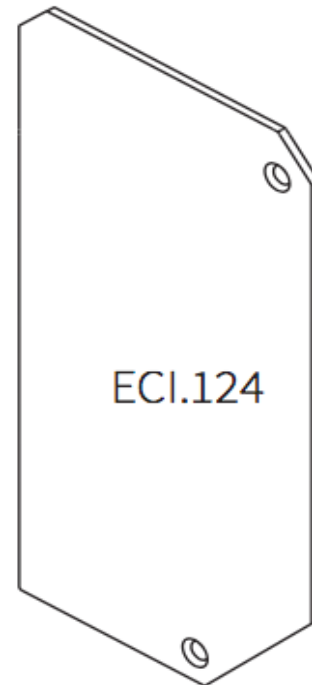
**GGSI.F / GGSI.R Glass Gasket Set Front and Rear****TECHNICAL DETAILS**

- GGSI.F - front
- GGSI.R - rear

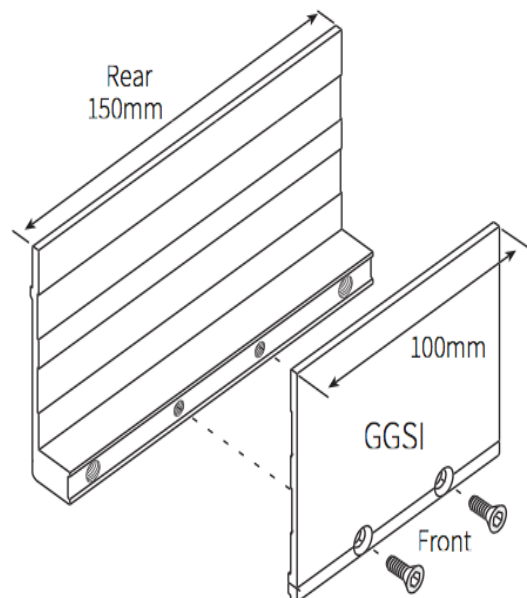

**GGL.12F / GGL.12R Glass Gasket For 12/15mm Glass Thickness****TECHNICAL DETAILS**

- GGL.12F (front for 12mm thick glass) - 2mm thick x 100mm wide
- GGL.12R (rear for 12mm thick glass) - 2mm thick x 150mm wide
- GGL.15F (front for 15mm thick glass) - 1mm thick x 100mm wide
- GGL.14R (rear for 15mm thick glass) - 1mm thick x 150mm wide

**AVAILABLE FINISHES**

- Natural anodised
- Mill

**GBS.124 Glass Bulb Seal**